

Things to Know About Gravity Feed Electric Steam Iron:

1) Power Failure

When you turn the iron on, light comes on the lamp.
if the base is not getting hot,

- a) Check thermal fuse
- b) Check heating element
- c) Check the power source

2) Water Leak

Gravity feed electric steam iron is the iron that the water goes in and generates the steam with the temperature inside of the iron. Whenever water goes into the iron, temperature is dropped each time. When you press thumb switch repeatedly in short period of time, if the temperature is not enough for the steam to be generated, the iron gives water instead of steam.

Temp. Setting	Application	Result When Thumb Switch Is Pressed
Setting 1, 2	Pre-heating. Temperature of the iron base is very low	Water flows
Setting 3	This setting is for fine fabric, and the temperature is still low and little steam is required.	Keep pressing thumb switch makes the water leak so badly. Just touch the thumb switch only when steam is needed.
Setting 4, 5	This setting is for regular and thick clothes. Temperature is high. Be cautious while in operation. Do not leave the iron unattended.	Safe setting for water leak. Water may leak if you keep pressing the thumb switch continuously longer than 40 seconds.

- 2) When you press thumb switch, you should hear the clicking sound from the solenoid valve unit that is on the right top of the iron. If you don't hear it, it could be one of the following cases;
- a) Valve spring lost its position and valve pin is stuck at the bottom --- Pull out the pin and spring from inside. You need to re-position the valve spring and pin.
 - b) Thumb switch is not working. ---- check and replace with a new part
 - c) Solenoid valve becomes defective ---- replace it

3) Less Steam

As you use the iron, even you are using filter resin, water residual like white plaster accumulates, and it may block the steam path. Therefore, you should clean inside the iron periodically. (once in every 3 ~ 4 months)

How to Clean: You should have the air compressor.

From Iron,
Remove the plastic cover.
Unscrew the angled nut in the top center of the iron base.
Blow out the dirt inside using air compressor gun
2 ~ 3 times.



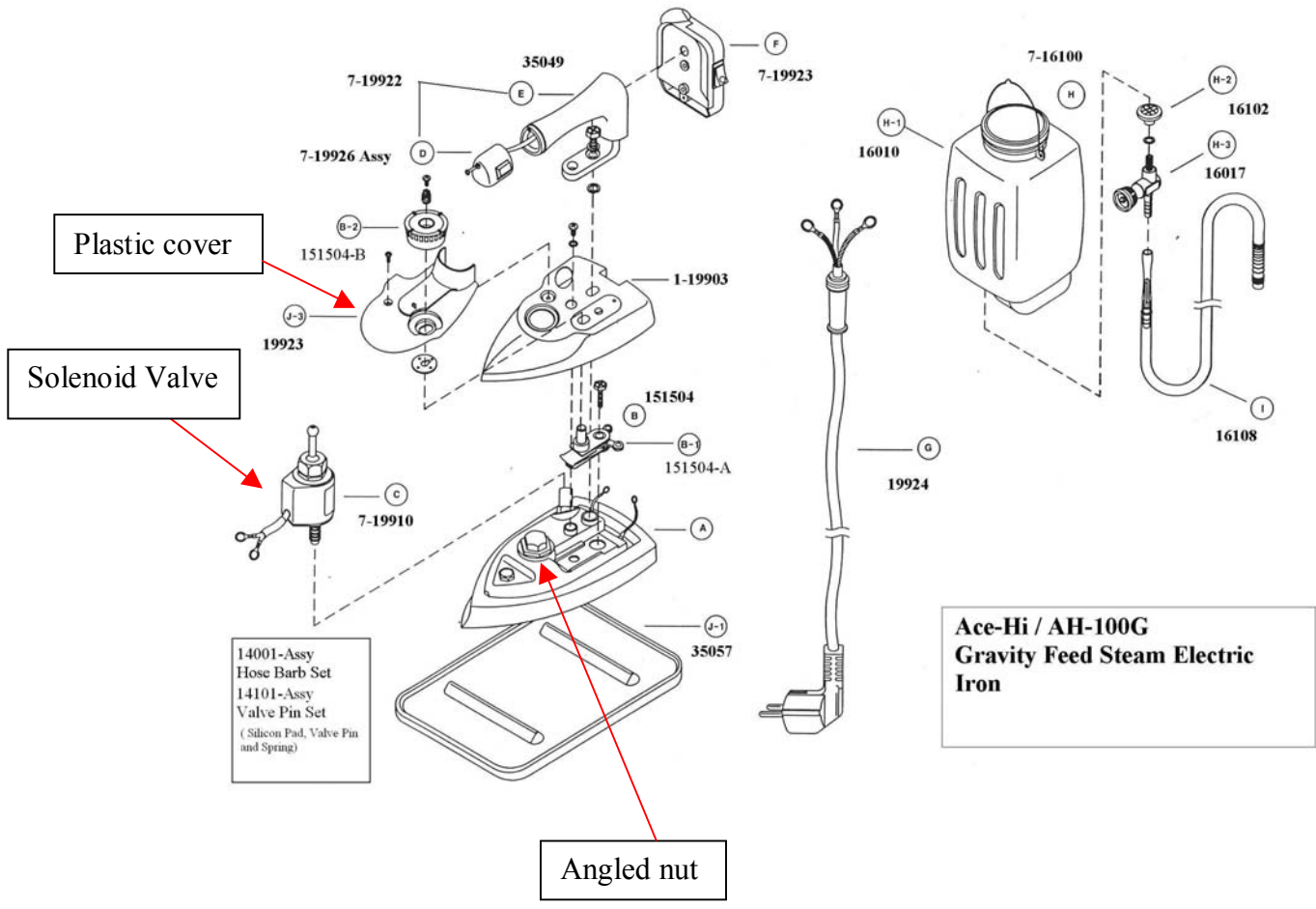

Mini Boiler with Electric Steam Iron



Mini boiler support:
You can place MSB-400
Mini boiler here .



Model: MSB-400

Advanced feature for gravity feed electric steam iron.

Uses Tap Water

Professional Industrial Iron

Operates at 40 PSI

Use Standard 15 amp electrical outlet (120V)

Contains 3 Liter of Water

Applicable Area: Alteration/ Tailors

Garment Factory Sample Room

Laundry & Dry Cleaners

Excellent for Touch-Up after the Boiler is Shut Down

SR-100U Vacuum Table

Perfect Match with MSB-400

Strong Vacuum at economical Price

Utility Shape Ironing Surface (45" x 15" x 9")

-- electrically heated

Self Contained Vacuum Motor

110V, 10 amp

Ship via UPS (80 lbs)