

# AMERICANA™

Luxury Sewing Furniture

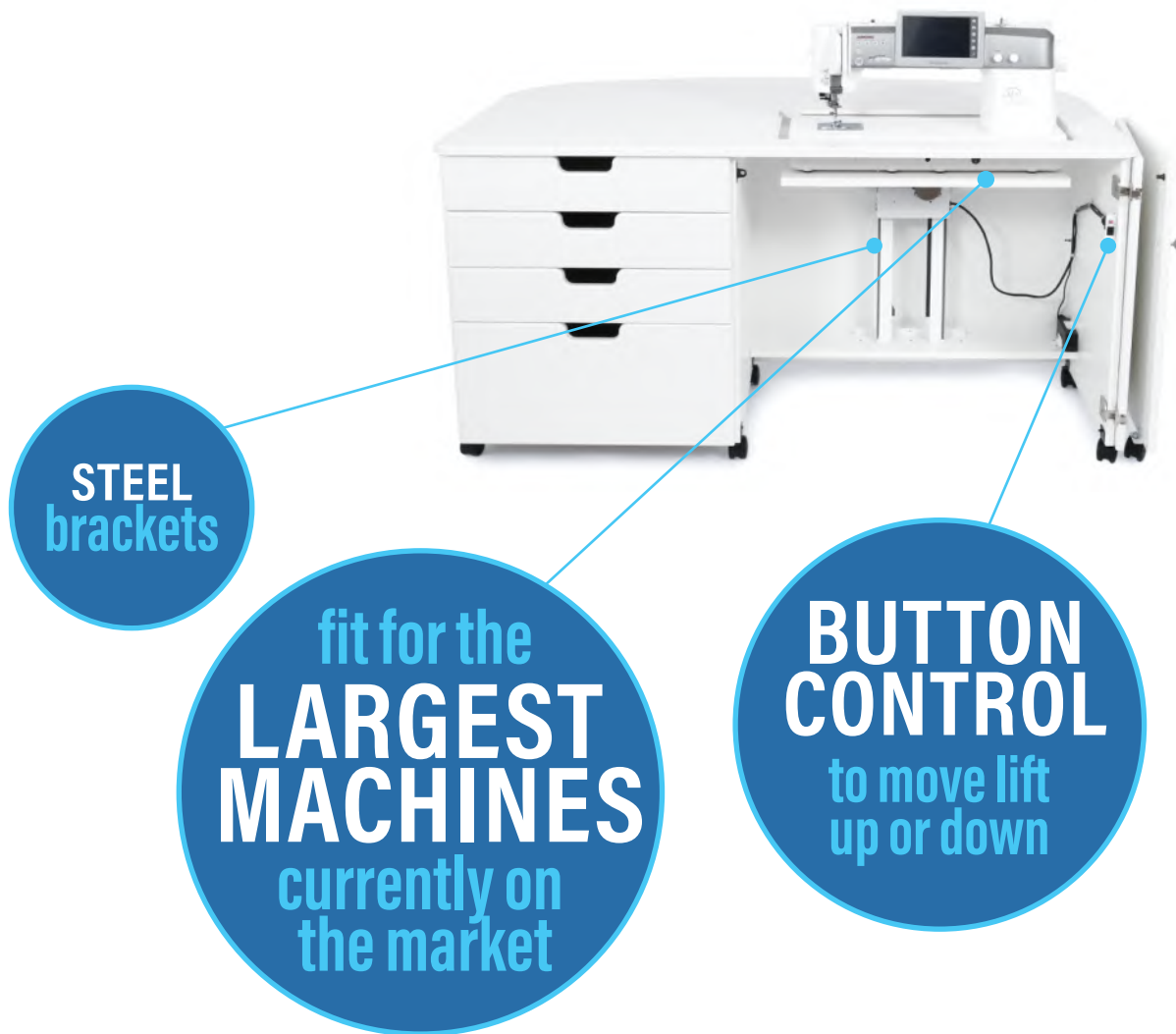

## Electric Lift Installation Instructions

## Included Hardware

• 5/8" wood screws	QTY 22
• Cord clamps	QTY 4
• V-brackets	QTY 2
• Electric lift wings	QTY 2
• 5/16" nuts (attached to body)	QTY 6
• Power Cord	QTY 1
• Auto-stop Instructions	

Note: The 5/8" wood screws provided are intended to work with 3/4" panels or thicker. Use substitute screws if necessary.

## Tools Needed

- Power drill with #2 Phillips Driver bit
- 1/2" wrench
- Mallet

## Step #1

Remove the power cord, power pack, wings and hardware package from the cavity of the electric lift body. The power pack should remain attached to the electric lift. The wings and hardware package are wrapped together.



## Step #2

Remove the nuts from the bolts on each side of the body - six total.



### Step #3

Put the bolts through the large holes of the wings. You may need to use a mallet to tap the wings onto the bolts. Replace and tighten the nuts with a 1/2" wrench.

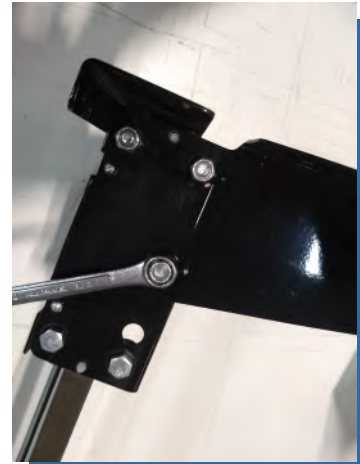

### Step #4

Place the power cord into the power pack and plug in the electric lift. Place the electric lift upright inside the cabinet, and in the desired position. The electric lift should be positioned forward enough so the wings don't catch underneath the cabinet top, and far enough back, so the screw holes aren't too close to the edge of the opening.

Putting the top bracket's front edge flush with the opening works for most cabinets. Secure the electric lift in place by putting three 5/8" wood screws through the top holes of the top frame-bracket, and into the under side of the top, using a power drill. To access the middle hole, lower the body and wings out of the way using the rocker switch.

Return the body and wings to the top position, after installing all three screws.

\*see separate auto-stop instructions to operate the lift up and down

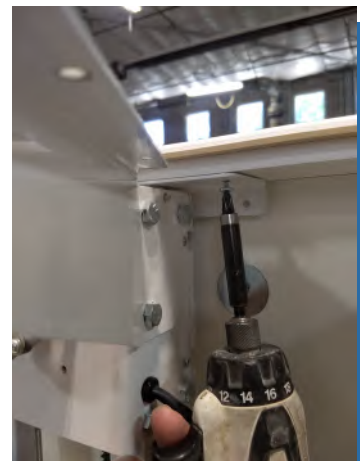
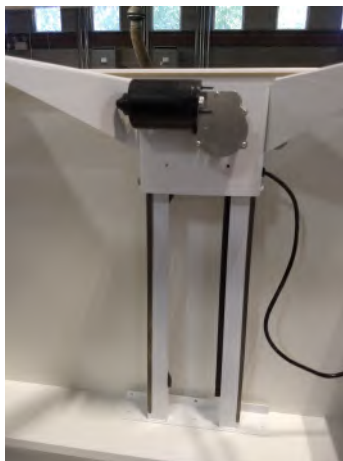

## Step #5

It can be helpful to place shims between the back of the bottom frame-bracket and the back of the cabinet. The shims are used to level the electric lift from front to back. They also reduce leverage on the top screws, when the weight of your sewing machine is first placed on the electric lift for installation purposes. You can use books, magazines, playing cards or business cards.

Place enough shims so that the electric lift is standing without a noticeable tilt. Thinner shims can be added or removed for fine adjustments at a later point.

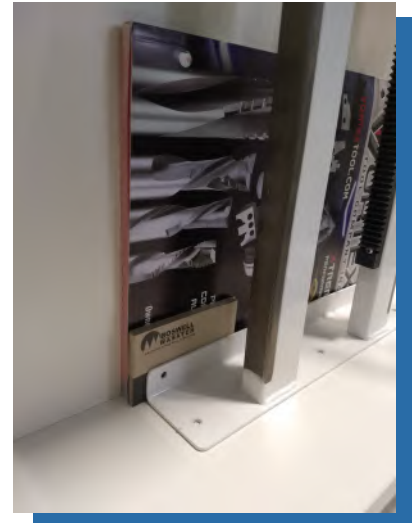

## Step #6

Once you have the electric lift somewhat level from front to back, place your chosen lift deck (the board that your sewing machine will sit on), on top of the electric lift's wings. Lift decks can be centered from front to back and side to side, but it can be useful to leave a larger space at the back - to make more room for your machine's cord to go through. Once the lift deck is in the desired position, use six 5/8" wood screws to secure it in place.

Put the screws up through the six holes in the wings (three in each wing), and into the bottom of the lift deck.

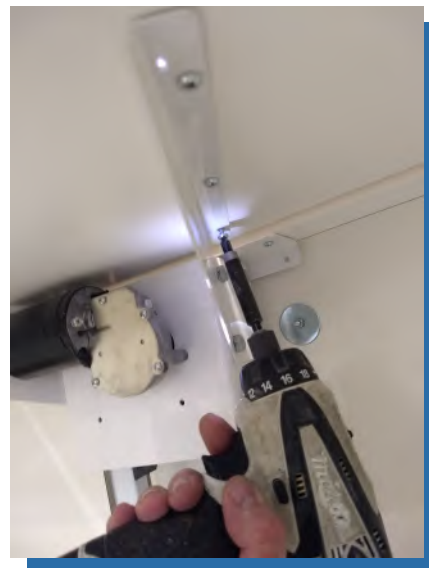
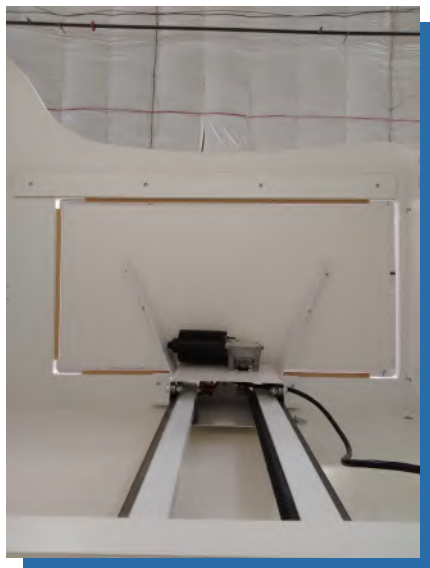

## Step #7

It is recommended that you place your sewing machine on the lift deck, in the position that you will be using it. This can contribute to properly leveling the lift for your specific machine. Adjust the back left corner of the lift deck until it's level with the top of the cabinet. This can be done by operating the electric lift up or down, and by shifting its bottom frame-bracket side to side.

Now add or remove shims until the front left corner is also level with the top of the cabinet. Add or remove thick shims for large adjustments, and thin shims for small adjustments.

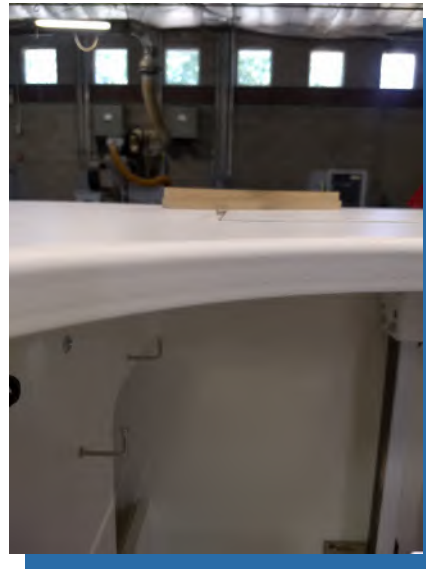

## Step #8

To level the lift from side to side, shift the bottom frame-bracket of the electric lift until the two front corners are level with each other. It may be useful to operate the lift up and down to see if the corners are level.

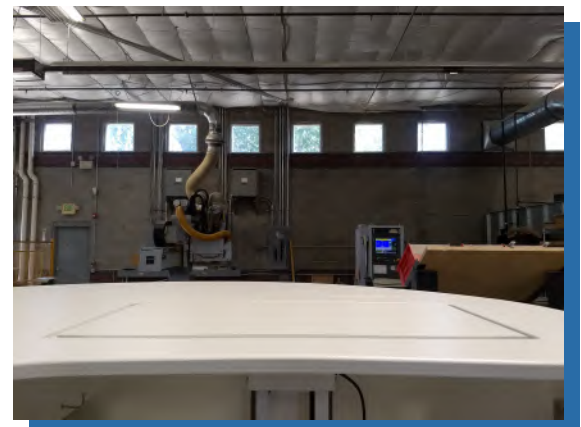



## Step #9

Once the lift deck is level, put three 5/8" wood screws through the bottom frame-bracket and into the bottom of the cabinet. The shims can now be removed.

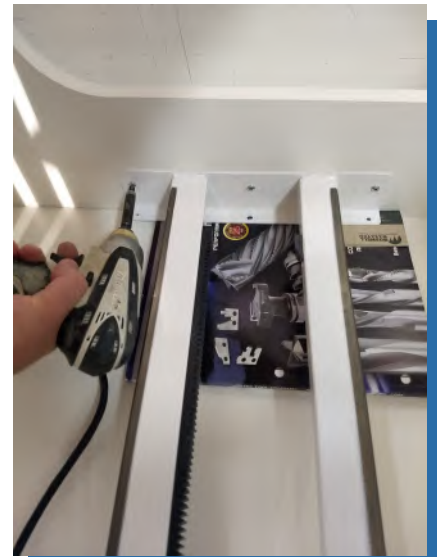

## Step #10

Unwind the cords and attach the switch bracket to the inside of the cabinet panel, using two 5/8" wood screws. Put the screws through the two holes in the switch-bracket, and into the panel. Be sure to place the bracket far enough inside the cabinet to allow the cabinet door to close (if there is one).

## Step #11

Route the cords along the panel wall as desired. Use the four 5/16" cord clamps and four 5/8" wood screws to attach the cords to the panel. Place the cord clamps around the cords and put a screw through the holes in the cord clamps, and into the panel. Be sure to route the cords in a way that allows the electric lift's body to fully move up and down its rack.



## Step #12

Place the power pack in the desired location, and use the two V-brackets to tightly hold it in place. Put four 5/8" wood screws through the holes in the two V-brackets and into the panel and bottom of the cabinet. Other configurations can also work to hold the power pack in place; such as placing the V-brackets on opposite sides of the power pack and pinching it in place.

Note: Be sure not to put screws into the power pack itself!



# The electric lift installation is complete.

Please contact [cs@arrowcabinets.com](mailto:cs@arrowcabinets.com) or call 1 (800) 533-7347 with any questions.

DONE

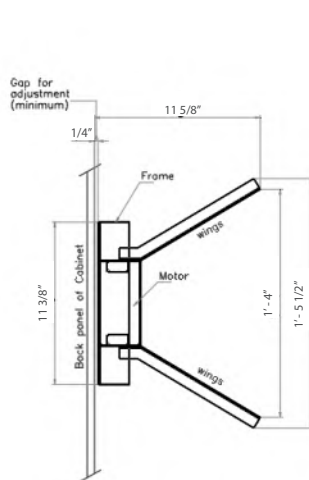

ElectricLift Top View

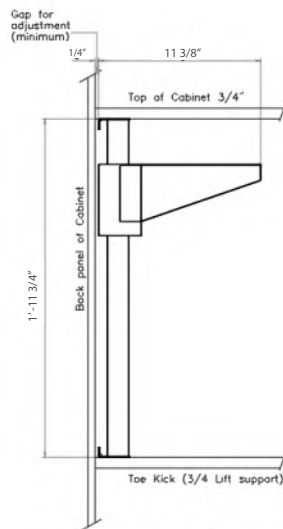

ElectricLift Side View

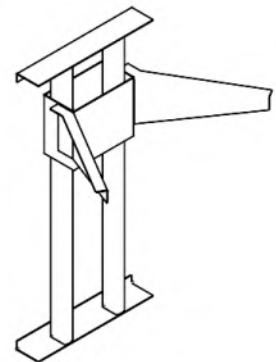

ElectricLift Isometric View