

Eastman®

The Eastman®

Hornet

Model HRNT:

20 Volt Heavy Duty Cordless Round Knife

Instruction Manual & Illustrated Parts List

Congratulations!

You have chosen an Eastman tool. Years of experience, thorough product development and innovation make Eastman one of the most reliable partners for professional power tool users.

Your new Hornet is designed to replace handheld shears for increased performance and capacity with a minimum of maintenance and service. Equipped with either a round knife for general use or a multi-sided knife for difficult to cut material.

TO OPERATE MACHINE

Raise the knife guard (A) just enough to allow the fabric in over the pressure foot and make contact with the Knife. To turn on the Hornet, squeeze the variable switch (C) and hold button to activate the Lock-off button (D) switch. If the tool does not perform properly check, the battery pack. Be sure the battery pack is properly charged and installed. Be sure the knife direction switch is fully depressed from the center safety position.

To adjust blade speed, slide RPM switch (E) to one of three positions: 10,000/17,500/25,000. See Fig 1.

TO SHARPEN KNIFE

Take the machine out of the material to be cut. Check knife rotation for counter-clockwise rotation. To obtain a fine, keen edge on the knife, while the machine is running, press lightly on the sharpener button (B) with constant pressure. Hold for 10 seconds, then release.

CAUTION

Machine Equipped
with Sharp knife

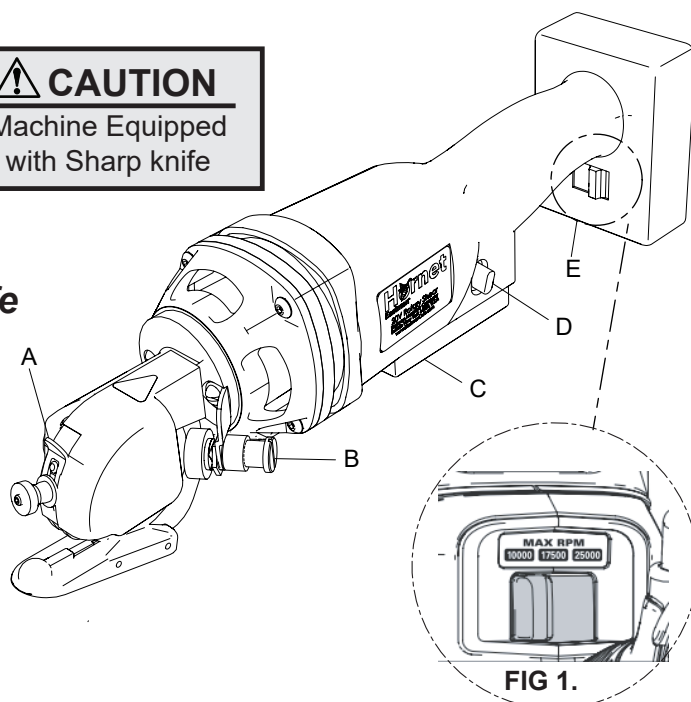

WARNING

Safety glasses must be worn at all times when operating or servicing this equipment.

LUBRICATION

Follow this procedure yearly for intermittent use, or every month for continuous use. Remove knife. Remove tension nut (4C3-12) and spring. Place a few drops of Eastman oil on knife rod (720C1-42). Remove sharpening stone (541C1-22) and wipe away any grit deposits. Apply a light coat of Eastman Lubriko Grease (242C2) to parts and reassemble. To lubricate gears, remove plug (54C4-35) and inject grease. Eastman Gear lubricant (242C2) is recommended. Be sure felt lubricator (191C1-26) is kept clean and moist with oil when changing the knife.

WARNING

Before performing any of the following procedures, make sure the battery power pack has been removed.

Eastman®

Over a Century of Cutting Expertise

779 Washington St., Buffalo, N.Y. 14203-1396 U.S.A. • (716)856-2200 • Fax (716)856-1140 or (716)856-2068

Manufacturers of Eastman Cloth Cutting and Cloth Spreading Machines

www.EastmanCuts.com

TABLE OF CONTENTS

Save These Instructions 3

Read All Instructions..... 3

General Power Tool Safety Warnings.....4

Save All Warnings And Instructions4

Safety Warnings Common for cutting.....5

Emery Wheel Replacement.....6

Installing And Removing The Battery Pack 7

Battery Protection System.....8

Fuel Gauge Battery Packs.....8

Knife Replacement8

Tool Care9

Maintenance9

Causes And Operator Prevention Of Kickback.....9

Service.....9

Hornet Illustrated Parts List 10

Technical Data 12



Read instruction manual before use.



Wear ear protection.



Wear eye proection.

SAVE THESE INSTRUCTIONS

The Battery pack is not fully charged out of the carton! First read the safety instructions below. Then follow charging notes and procedures.

 **Important Safety Instructions (For Battery Packs and Charger)**

 **WARNING:** When using electric tools, basic safety precautions should always be followed to reduce the risk of fire, electric shock, and personal injury, including the following:

READ ALL INSTRUCTIONS

Do not store -or- carry battery such that metal objects can contact exposed metal end. For example, do not place battery in aprons, toolboxes, pockets, drawers, desk, etc... with loose nails, screws, keys, etc... without battery cap. The battery pack could short circuit causing fire, burns, or damage to the battery.

 **DANGER:** Never attempt to open the battery pack for any reason. If the housing of the battery breaks -or- cracks, immediately discontinue use and do not recharge.

- Do not incinerate the battery pack as it can explode in a fire. A small leakage of liquid from the battery cells may occur under extreme usage, charging, or temperature conditions. This does not indicate a failure. However, if the outer seal is broken and this leakage contacts your skin:
 - a. Wash quickly with soap and water;
 - b. Neutralize with a mild acid such as vinegar-or-lemon juice.
 - c. If the battery liquid gets in your eyes, flush them with clean water for a minimum of ten (10) minutes and seek immediate medical attention.

Medical Note:

The liquid is a 25-35% solution of potassium hydroxide.

- Charge batteries only with Eastman charger.
 - Do not use the charger in wet-or-damp conditions. It is intended for indoor use only. Do not use near sinks, tubs, etc... Do not immerse in water.
 - Do not use the charger for any uses other than charging Eastman battery packs. Other batteries may explode.
 - Do not operate charger with a damaged cord -or- plug...have them replaced immediately.
 - Do not operate charger if it has received a sharp blow, been dropped, or otherwise damaged in any way; contact your qualified Eastman representative for service.
- Do not disassemble charger; contact your qualified Eastman representative when service -or- repair is required. The incorrect assembly may result in a risk of electric shock -or- fire. There are no consumer serviceable parts inside.
 - For best results, do not charge batteries when they -or- the air temperature is BELOW +40° Fahrenheit -or- ABOVE +105° Fahrenheit.
 - The charger is designed to operate on standard household electrical power (120 Volts AC). Do not attempt to use it on any other voltage. Be sure your power supply agrees with the nameplate marking.
 - Unplug the charger when not in use.
 - Do not abuse the charger cord. To reduce the risk of damage to the electric plug and cord, never carry charger by cord -or- sharply pull it to disconnect from receptacle. Keep the charger cord from heat, oil, and sharp edges.
 - Use only the charger supplied by Eastman to recharge batteries.

Eastman®

Over a Century of Cutting Expertise

GENERAL POWER TOOL SAFETY WARNINGS

WARNING: Read all safety warnings and all **INSTRUCTIONS:** Failure to follow the warnings and instructions may result in electric shock, fire and/or serious injury.

SAVE ALL WARNINGS AND INSTRUCTIONS FOR FUTURE REFERENCE

The term “power tool” in the warnings refers to your battery-operated (cordless) power tool.

1) Work area safety

- a. **Keep the work area clean and well lit.** Cluttered or dark areas invite accidents.
- b. **Do not operate power tools in explosive atmospheres, such as in the presence of flammable liquids, gases or dust.** Power tools create sparks which may ignite the dust or fumes.
- c. **Keep children and bystanders away while operating** a power tool. Distractions can cause you to lose control.

2) Electrical Safety

- a. **Power tool plugs must match the outlet.** Never modify the plug in any way. Do not use any adapter plugs with earthed (grounded) power tools. Unmodified plugs and matching outlets will reduce the risk of electric shock.
- b. **Avoid body contact with earthed or grounded surfaces such as pipes, radiators, ranges, and refrigerators.** There is an increased risk of electric shock if your body is earthed or grounded.
- c. **Do not expose power tools to rain or wet conditions.** Water entering a power tool will increase the risk of electric shock.
- d. **Do not abuse the cord. Never use the cord for carrying, pulling or unplugging the power tool.** Keep cord away from heat, oil, sharp edges or moving parts. Damaged or entangled cords increase the risk of electric shock.
- e. **When operating a power tool outdoors, use an extension cord suitable for outdoor use.** The use of a cord suitable for outdoor use reduces the risk of electric shock.
- f. **If operating a power tool in a damp location is unavoidable, use a residual current device (RCD) protected supply.** The use of an RCD reduces the risk of electric shock.

3) Personal safety

- a. **Stay alert, watch what you are doing and use common sense when operating a power tool.** Do not use a power tool while you are tired or under the influence of drugs, alcohol or medication. A moment of inattention while operating power tools may result in serious personal injury.
- b. **Use personal protective equipment. Always wear eye protection.** Protective equipment such as dust masks, non-skid safety shoes, hard hat, or hearing protection used for appropriate conditions will reduce personal injuries.
- c. **Prevent unintentional starting. Ensure the switch is in the off position before connecting to a power source and/or battery pack, picking up or carrying the tool.** Carrying power tools with your finger on the switch or energizing power tools that have the switch on invites accidents.
- d. **Remove any adjusting key or wrench before turning the power tool on.** A wrench or a key left attached to a rotating part of the power tool may result in personal injury.
- e. **Do not overreach. Keep proper footing and balance at all times.** This enables better control of the power tool in unexpected situations.
- f. **Dress properly. Do not wear loose clothing or jewelry.** Keep your hair, clothing, and gloves away from moving parts. Loose clothes, jewelry or long hair can be caught in moving parts.
- g. **If devices are provided for the connection of dust extraction and collection facilities, ensure these are connected and properly used.** The use of dust collection can reduce dust-related hazards.

4) Power tool use and care

- a. **Do not force the power tool.** Use the correct power tool for your application. The correct power tool will do the job better and safer at the rate for which it was designed.
- b. **Do not use the power tool if the switch does not turn it on and off.** Any power tool that cannot be controlled with the switch is dangerous and must be repaired.
- c. **Disconnect the plug from the power source and/or the battery pack from the power tool before making any adjustments, changing accessories, or storing power tools.** Such preventive safety measures reduce the risk of starting the power tool accidentally.
- d. **Store idle power tools out of the reach of children and do not allow persons unfamiliar with the power tool or these instructions to operate the power tool.** Power tools are dangerous in the hands of untrained users.
- e. **Maintain power tools. Check for misalignment or binding of moving parts, breakage of parts and any other condition that may affect the power tool's operation.** If damaged, have the power tool repaired before use. Many accidents are caused by poorly maintained power tools.
- f. **Keep cutting tools sharp and clean.** Properly maintained cutting tools with sharp cutting edges are less likely to bind and are easier to control.
- g. **Use the power tool, accessories and tool bits, etc., in accordance with these instructions taking into account the working conditions and the work to be performed.** The use of the power tool for operations different from those intended could result in a hazardous situation.

5) Battery tool use and care

- a. **Recharge only with the charger specified by the manufacturer.** A charger that is suitable for one type of battery pack may create a risk of fire when used with another battery pack.
- a. **Use power tools only with specifically designated battery packs.** The use of any other battery packs may create a risk of injury and fire.
- b. **When battery pack is not in use, keep it away from other metal objects like paper clips, coins, keys, nails, screws or other small metal objects that can make a connection from one terminal to another.** Shorting the battery terminals together may cause burns or a fire.

- c. **Under abusive conditions, liquid may be ejected from the battery; avoid contact.** If contact accidentally occurs, flush with water. If liquid contacts eyes, additionally seek medical help. Liquid ejected from the battery may cause irritation or burns.

6) Service

- a. **Have your power tool serviced by a qualified repair person using only identical replacement parts.** This will ensure that the safety of the power tool is maintained.

SAFETY WARNINGS COMMON FOR CUTTING.

- a. **This power tool is intended to function as a cutter.** Read all safety warnings, instructions, illustrations and specifications provided with this power tool. Failure to follow all instructions listed below may result in electric shock, fire and/or serious injury.
- b. **Operations such as sanding, wire brushing, polishing, and cutting-off are not recommended to be performed with this power tool.** Operations for which the power tool was not designed may create a hazard and cause personal injury.
- c. **Do not use accessories that are not specifically designed and recommended by the tool manufacturer.** Just because the accessory can be attached to your power tool, it does not assure safe operation.
- d. **The rated speed of the accessory must be at least equal to the maximum speed marked on the power tool.** Accessories running faster than their rated speed can break and fly apart.
- e. **The outside diameter and the thickness of your accessory must be within the capacity rating of your power tool.** Incorrectly sized accessories cannot be adequately guarded or controlled.
- f. **The arbor size of wheels, flanges, backing pads or any other accessory must properly fit the spindle of the power tool.** Accessories with arbor holes that do not match the mounting hardware of the power tool will run out of balance, vibrate excessively and may cause loss of control.
- g. **Do not use a damaged accessory.** Before each use inspect the accessory such as abrasive wheel for chips and cracks, backing pad for cracks, tear or excess wear, wire brush for loose or cracked wires. If power tool or accessory is dropped, inspect for damage or install an undamaged accessory. After inspecting and installing an accessory, position yourself and bystanders away from the plane of the rotating accessory and run the power tool at maximum no-load speed for one minute. Damaged accessories will normally break apart during this test time.

Eastman®

Over a Century of Cutting Expertise

- h. **Wear personal protective equipment.** Depending on the application, use face shield, safety goggles or safety glasses. As appropriate, wear a dust mask, hearing protectors, gloves and workshop apron capable of stopping small abrasive or workpiece fragments. The eye protection must be capable of stopping flying debris generated by various operations. The dust mask or respirator must be capable of filtering particles generated by your operation. Prolonged exposure to high-intensity noise may cause hearing loss.
- i. **Keep bystanders a safe distance away from the work area.** Anyone entering the work area must wear personal protective equipment. Fragments of the workpiece or of a broken accessory may fly away and cause injury beyond the immediate area of operation.
- j. **Hold the power tool by insulated gripping surfaces only, when performing an operation where the cutting tool may contact hidden wiring.** Contact with a "live" wire will also make exposed metal parts of the power tool "live" and could give the operator an electric shock.
- k. **Always hold the tool firmly in your hand(s) during startup.** The reaction torque of the motor, as it accelerates to full speed, can cause the tool to twist.
- l. **Use clamps to support the workpiece whenever practical. Never hold a small workpiece in one hand and the tool in the other while in use.** Clamping a small workpiece allows you to use your hand(s) to control the tool. Round material such as dowel rods, pipes or tubing have a tendency to roll while being cut and may cause the bit to bind or jump toward you.
- m. **Never lay the power tool down until the accessory has come to a complete stop.** The spinning accessory may grab the surface and pull the power tool out of your control.

- n. **After changing bits or making any adjustments, make sure the collet nut, chuck or any other adjustment devices are securely tightened.** Loose adjustment devices can unexpectedly shift, causing loss of control, loose rotation components will be violently thrown.
- o. **Do not run the power tool while carrying it at your side.** Accidental contact with the spinning accessory could snag your clothing, pulling the accessory into your body.
- p. **Regularly clean the power tool's air vents.** The motor's fan will draw the dust inside the housing and excessive accumulation of powdered metal may cause electrical hazards.
- q. **Do not operate the power tool near flammable materials.** Sparks could ignite these materials.
- r. **Do not use accessories that require liquid coolants.** Using water or other liquid coolants may result in electrocution or shock.

EMERY WHEEL REPLACEMENT

Remove the battery pack from Hornet. With Hornet on its side (knife facing up) and Disengage Sharpener, remove guards. Remove Sharpener by removing the round head screw from the sharpener bracket (636C1-3). Sharpening stone and bushing assembly can then be removed. Hold sharpener bushing (21C5-4) with 1/2" wrench and remove sharpener button (63C3-21) and spring with a flat screwdriver. Remove retaining ring from a shaft of sharpening stone and remove the stone. To Install, assemble in reverse order.

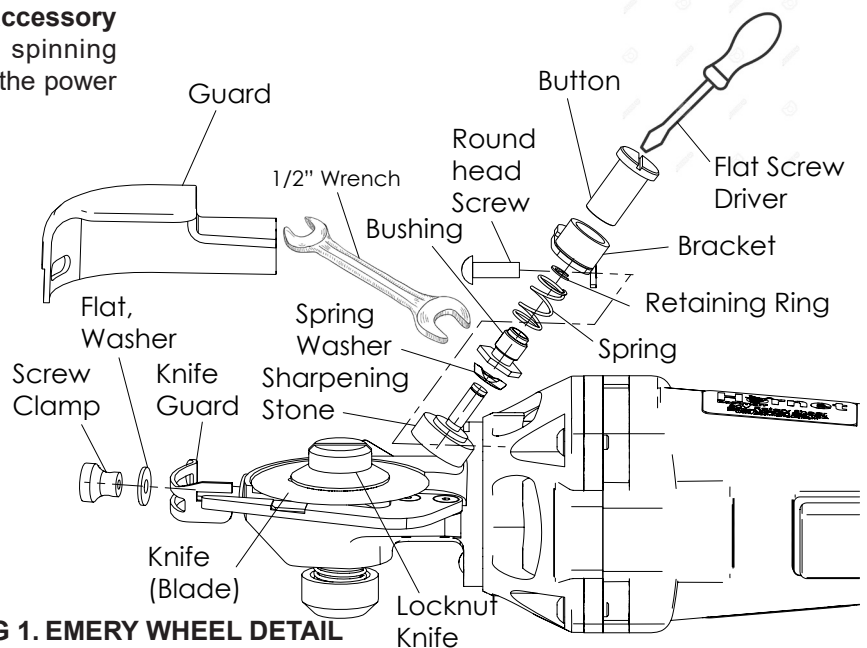

FIG 1. EMERY WHEEL DETAIL

INSTALLING AND REMOVING THE BATTERY PACK

CAUTION:

Always be sure that the tool is switched off and the battery cartridge is removed before adjusting or checking function on the tool.

CAUTION:

Always switch off the tool before installing or removing of the battery cartridge.

CAUTION:

Hold the tool and the battery cartridge (FIG. 1) firmly when installing or removing battery cartridge. Failure to hold the tool and the battery cartridge firmly may cause them to slip off your hands and result in damage to the tool and battery cartridge and a personal injury.

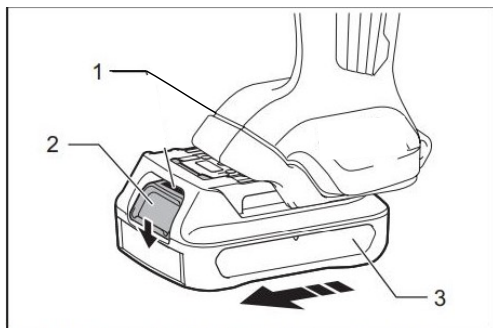

NOTE: Make sure your battery pack is fully charged.

To install the battery pack into the handle, align the battery base with the handle and slide the battery pack firmly into the handle until you hear the lock snap into place.

To remove the battery pack from the handle, press the release buttons and firmly pull the battery pack out of the handle. Insert battery pack into charger.

CHARGING PROCEDURE

1 Hour Charger

1. Plug the charger into the appropriate outlet.
2. Insert the battery pack into the charger making sure the pack is fully seated. The red (charging) light will blink continuously indicating that the charging process has started.
3. The battery pack will be fully charged in about 1 hour. The completion of the charge will be indicated by the red light remaining ON continuously. The pack is fully charged and may be used at this time or left in the charger.

Trouble Indicator

This charger is designed to detect certain problems that can arise with battery packs. The red indicator light will flash at a fast rate. If this occurs, reinsert the battery pack. If the problem persists, try a different battery pack to determine if the charger is OK. If the new pack charges correctly, then the original pack is defective and should be recycled.

Leaving the battery pack into the charger

When the red light remains on, the charger has switched to its "equalize charge" mode which last about 4 hours, after which the charger will switch to "maintenance mode". The battery pack can be remove at any time during these cycles but will only be fully charged if the red light is continuously on. The battery pack and the charger can be left connected with the red light glowing indefinitely. This will keep the battery pack fresh and fully charged.

Important Charging Notes:

- Longest life and best performance can be obtained if the battery pack is charged when the air temperature is between 65°F and 75°F. Do not charge the battery pack in an air temperature below +40°F or above +105°F. This is important and will prevent serious damage to the battery pack.
- While charging, the charger and battery pack may become warm. This is a normal condition and does not indicate a problem.
- If a battery does not charge properly – 1.) Check current at receptacle by plugging in a lamp –or– other appliance; 2.) Check to see if receptacle is connected to a light switch that turns power off when you turn out the lights; 3.) Move charger and battery pack to a surrounding air temperature between +40°F to +105°F; 4.) If the receptacle and temperature are satisfactory, and you do not get proper charging, take –or– send the batteries and charger to your local Eastman representative for service.
- The battery pack should be recharged when they fail to produce sufficient power on jobs that were easily performed previously. **DO NOT CONTINUE** to use the machine with its batteries in a depleted condition.

Eastman®

Over a Century of Cutting Expertise

BATTERY PROTECTION SYSTEM

The tool is equipped with a battery protection system. This system automatically cuts off power to the motor to extend battery life. The tool will automatically stop during operation if the tool and/or battery are placed under one of the following conditions:

Overloaded:

The tool is operated in a manner that causes it to draw an abnormally high current. In this situation, turn the tool off and stop the application that caused the tool to become overloaded. Then turn the tool on to restart. If the tool does not start, the battery is overheated. In this situation, let the battery cool before turning the tool on again.

Low battery voltage:





The remaining battery capacity is too low and the tool will not operate. If you turn the tool on, the motor runs again but stops soon. In this situation, remove and recharge the battery.

Indicating the remaining battery capacity

Press the check button on the battery cartridge to indicate the remaining battery capacity. The indicator lamps light up for a few seconds.

FUEL GAUGE BATTERY PACKS (FIG. 3)

Some battery packs include a fuel gauge which consists of three green LED lights that indicate the level of charge remaining in the battery pack. The fuel gauge is an indication of approximate levels of charge remaining in the battery pack according to the following indicators:

	75–100% charged
	51–74% charged
	< 50% charged
	Pack needs to be charged

KNIFE REPLACEMENT

Set the Lock-off button to the middle safety position. Remove the battery pack from Hornet. Lay Hornet on its side with a knife facing up. Remove Knife guard, Screw clamp and knife, guard. Insert a pin or allen wrench into a knife hole. With large screwdriver turn-lock nut (4C1-194) ITEM 1 counterclockwise. Remove lock nut. CAREFULLY lift out WORN SHARP KNIFE, ITEM 2 and DISCARD WITH CARE. Lubricate wick with a few drops of Eastman oil. Install a new Eastman knife with the bevel facing outward. Reverse procedure to secure a new knife.

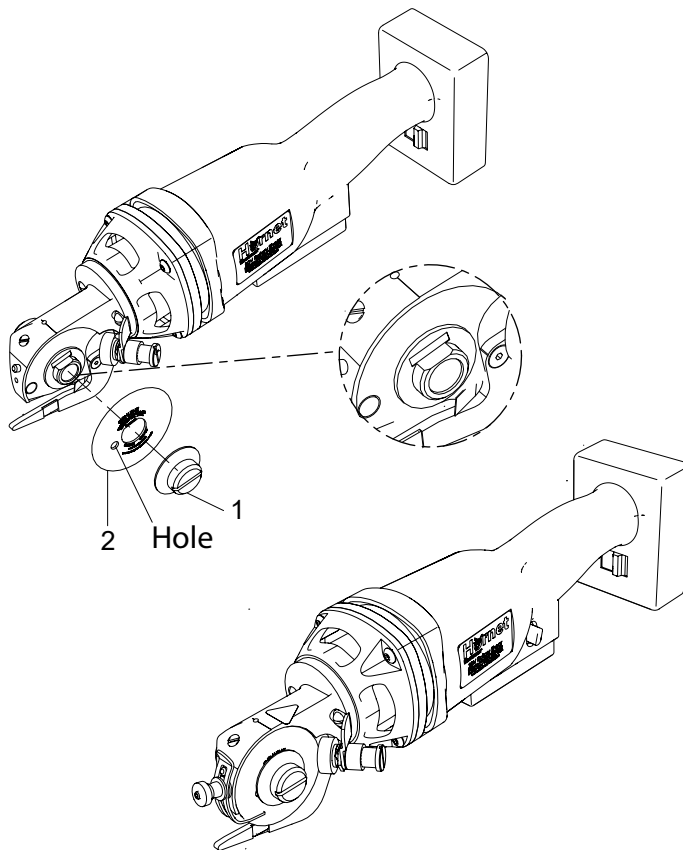

(FIG. 4) 1. LOCKNUT, 2. Knife

TOOL CARE

- Do not force tool. Use the correct tool for your application.
- Disconnect battery pack from tool or place switch in the locked position before making any adjustments, changing accessories, or storing the tool. Such preventative safety measures reduce the risk of starting the tool accidentally.
- Maintain tools with care. Keep the knife sharp and clean. Properly maintained tools with sharp cutting edges are less likely to bind and are easier to control.
- Use only Eastman accessories with your Hornet. Accessories that may be suitable for one tool may create a risk of injury when used with another.

MAINTENANCE

Your Eastman power tool has been designed to operate over a long period of time with a minimum of maintenance. Continuous satisfactory operation depends upon proper tool care and regular cleaning.



WARNING: To reduce the risk of serious personal injury, turn tool off and disconnect battery pack before making any adjustments or removing/installing attachments or accessories.

An accidental start-up can cause injury.

The charger and battery pack are not serviceable.



CLEANING



WARNING: Blow dirt and dust out of the main housing with dry air as often as dirt is seen collecting in and around the air vents. Wear approved eye protection and approved dust mask when performing this procedure.



WARNING: Never use solvents or other harsh chemicals for cleaning the non-metallic parts of the tool. These chemicals may weaken the materials used in these parts. Use a cloth dampened only with water and mild soap. Never let any liquid get inside the tool; never immerse any part of the tool into a liquid.

CAUSES AND OPERATOR PREVENTION OF KICKBACK

- Kickback is a sudden reaction to a pinched or snagged rotating wheel, backing pad, brush or any other accessory. Pinching or snagging causes rapid stalling of the rotating accessory which in turn causes the uncontrolled power tool to be forced in the direction opposite of the accessory's rotation at the point of the binding.

For example, if the Knife is snagged or pinched by the workpiece, the edge of the Knife that is

entering into the pinch point can dig into the surface of the material causing the Knife to climb out or kick out. The wheel may either jump toward or away from the operator, depending on the direction of the wheel's movement at the point of pinching. Abrasive wheels may also break under these conditions.

Kickback is the result of tool misuse and/or incorrect operating procedures or conditions and can be avoided by taking proper precautions as given below:

- Maintain a firm grip on the power tool and position your body and arm to allow you to resist kickback forces.** Always use auxiliary handle, if provided, for maximum control over kickback or torque reaction during start-up. The operator can control torque reaction or kickback forces if proper precautions are taken.
- Use special care when working corners, sharp edges, etc. Avoid bouncing and snagging the accessory.** Corners, sharp edges or bouncing have a tendency to snag the rotating accessory and cause loss of control or kickback.
- Do not attach a saw chain wood carving blade or toothed saw blade.** Such blades create frequent kickbacks and loss of control.
- Always feed the blade into the material in the same direction as the cutting edge is exiting from the material.** Feeding the tool in the wrong direction causes the cutting edge of the bit to climb out of the work and pull the tool in the direction of this feed.

SERVICE

- Tool service must be performed only by qualified repair personnel.
- When servicing a tool, use only Genuine Eastman replacement parts.

The RBRC Seal



The RBRC (Rechargeable Battery Recycling Corporation) Seal on the NiCd battery (or battery pack) indicates that costs to recycle the battery (or battery pack) at the end of its useful life have already been paid. In some areas, it is illegal to place spent NiCd batteries in the trash—or- municipal solid waste streams. The RBRC program provides an environmentally conscious alternative.

RBRC in cooperation with other battery users has established programs in the United States and Canada to facilitate the collection of spent NiCd batteries. Help protect our environment and conserve natural resources by returning the spent NiCd battery to your local recycling center. You may also contact your local recycling center for information on where to drop off the spent battery, or call 1-800-8-Battery.

Eastman®

Over a Century of Cutting Expertise

Eastman®

Hornet

Illustrated Parts List

ITEM	PART NO.	DESCRIPTION	QTY.
1	647C1-1	Standard with Shaft	1
2	300C12-6	Screw, Round. HD. #8-32 X 1/2	2
3	34C10-163	Spring, Knife Gear	1
4	4C3-12	Nut, Adjust	1
5	17C15-127	Pin for Standard	1
6	236C1-184	Label, Blade Hazard	1
7	25C4-197	Blade Guard, U-level	1
8	20C5-21	Screw Clamp	1
9	12C15-95	Washer, Flat	2
10	25C4-150	Knife Guard	1
11	20C13-56	Cup Point Set Screw #6-32 x 3/4	1
12*	109C5-1	Shear Plate Tip	1
13*	68C3-4	Shear Plate Foot	1
14*	309C8-1	Screw, Skt. Set #4-40 x 1/4	2
15*	95C5-7	Wrench Hex Allen Chk	1
16	637C1-12	Sharpener	1
17	726C1-5	Shear Plate	1
18	20C12-117	Screw, Skt Flat Head #6-32 X 3/8	2
19	524C1-21	Phenolic Gear.	1
20	80C1-127	2 1/32" Knife Round	1
*	80C1-123	Knife, 4-Sided (Semi-Square)	1
*	80C1-133	Knife, 8-Sided (Octagon)	1
21	720C1-42	Knife Rod And Bearing	1

ITEM	PART NO.	DESCRIPTION	QTY.
22	4C1-194	Locknut, Knife	1
23	191C1-26	Oil Felt For Knife	1
24	287C1-5	Hornet Battery 20V	2
25	2361-192	Decal Sheet, Hornet	1
26	288C1-8	110V Battery Charger, Hornet	1
	288C1-9	220V 2-Prong Battery Charger, Hornet	1
27	653C1-1	Worm with Shaft and Bearing	1
28	18C6-35	Snap Retaining Ring	1
29	29C6-189	Adaptor, Hornet Knife Housing	1
30	822C1-3	Coupling, Hornet	2
31	804C1-4	Hornet Housing Assembly	1
32	637C1-12	Sharpener	1
33	541C1-22	Sharpening Stone, 180	1
34	12C15-57	Spring Washer	1
35	21C5-4	Sharpener Bushing	1
36	34C10-131	Sharpener Spring	1
37	636C1-3	Sharpener Bracket	1
38	18C6-23	Retaining Ring	1
39	63C3-21	Button Sharpener	1
40	17C15-120	Spring Pin	1
41	20C12-184	Screw, Torx, Rnd. HD., #8-16x1	4
42	79C2-90	Name Plate, Hornet	1
*43	25C4-192	Pelican Style Knife Guard	1
*44	302C8-7	Screw, Flat Hd. #4-40 x 3/16	2
*45	68C3-18	Pelican Shear Foot	1
*46	726C1-37	Pelican Shear Plate	1
*47	820C1-126	Pelican Option Kit	1

* Indicates Optional Items

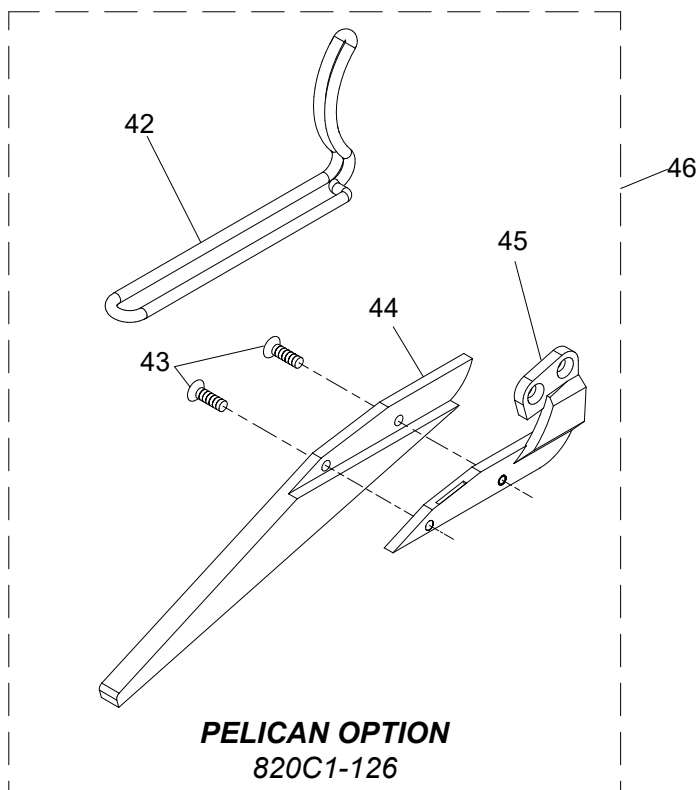

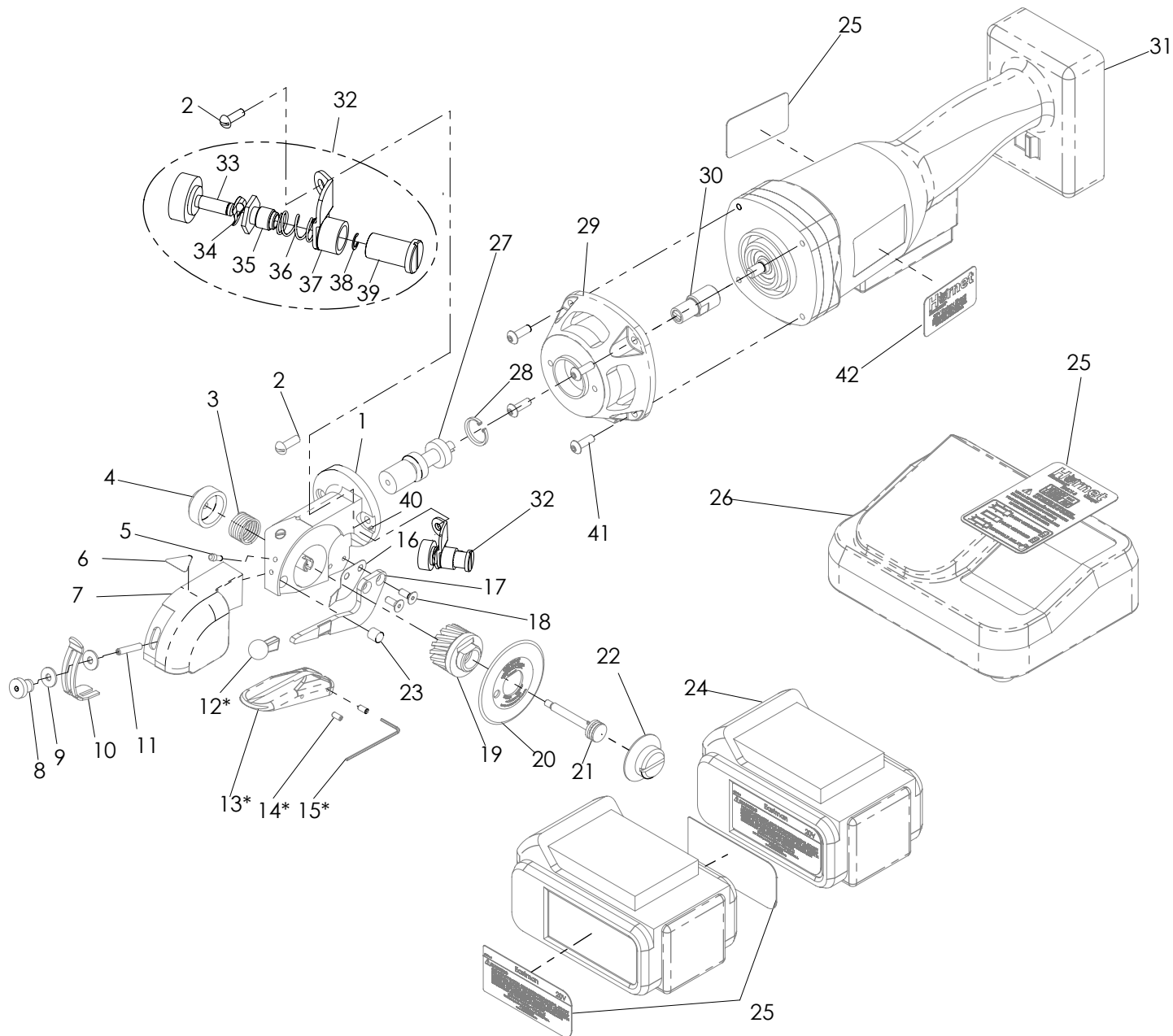

To order replacement parts call Customer Service at (716) 856-2201 Ext. 500. Please specify model and serial number of machine along with part number, description and quantity of parts in order.

Eastman®

Over a Century of Cutting Expertise

TECHNICAL DATA

Eastman® Hornet

Hornet

Weight	4 lbs (1.8kg)
Max Blade RPM (Motor Speed)	8,400 RPM
Vibration.....	1.1 m/s ² per ISO 28927-8:2016
Sound Power Level.....	82dBA per ISO 15744:2002
Blade Size	2 1/32 (5.16cm)
Cutting Capacity	0.38in (0.96cm)

Limited Warranty. Eastman warrants to the buyer that the Hornet shall be free from defects in materials or workmanship for a period of 6 months commencing on the date of the invoice. Any goods or parts claimed by the buyer to be defective must be returned to Eastman, freight charges prepaid, within the 6 month warranty period. If Eastman determines that the goods or parts are defective in materials or workmanship, Eastman's sole obligation under this warranty shall be, at Eastman's sole option, to repair or replace the defective goods or parts or to provide to the buyer a credit equal to the portion of the purchase price allocable to the defective goods or parts. This warranty shall not apply if defects are caused by product misuse or neglect, if the machine has been altered or modified by the buyer, or if other than genuine Eastman belts, emery wheels, knives or parts are used in the machine. THIS WARRANTY IS THE ONLY WARRANTY APPLICABLE TO THIS PURCHASE. SELLER DISCLAIMS ALL OTHER WARRANTIES, EXPRESS OR IMPLIED, INCLUDING, BUT NOT LIMITED TO, THE IMPLIED WARRANTIES OF MERCHANTABILITY AND FITNESS FOR A PARTICULAR PURPOSE.

Limitation of Liability. Eastman's liability to the buyer, and the buyer's remedies from Eastman, whether in contract, negligence, tort, under any warranty or otherwise, shall be limited to the remedies provided in the foregoing Limited Warranty. In no event shall Eastman have any responsibility or liability to the buyer for (a) any special, indirect, incidental, or consequential damages, including, but not limited to, loss of use, revenue, or profit, even if Eastman has been advised of the possibility of such damages, or (b) any claim against the buyer by any third party. The price stated for the product sold is a consideration for limiting Eastman's liability.

Eastman®

Over a Century of Cutting Expertise

779 Washington St., Buffalo, N.Y. 14203-1396 U.S.A. • (716)856-2200 • Fax (716)856-1140 or (716)856-2068

Manufacturers of Eastman Cloth Cutting and Cloth Spreading Machines

www.EastmanCuts.com